



RESTROOM ACCESSORIES

1191

MURDOCK-SUPER SECUR FACILITIES ACCESSORIES

MODEL #
1190 SERIES

WATER HEATER

1190 1191 1192

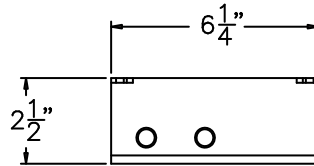

TOP VIEW

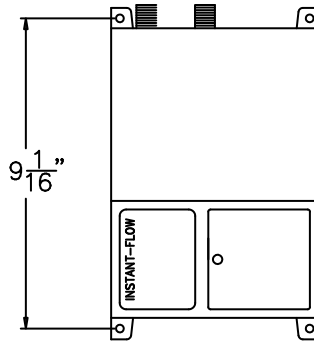

FRONT VIEW



Note: Photo may show some available options.

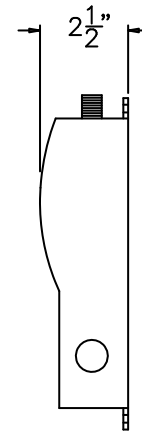

SIDE VIEW

TECHNICAL DATA:

1190 Instant-Flow® tankless heater is manufactured by Chronomite Laboratories, Inc. Water is heated only when water flows. Waterways are Celcon and heating coils are stainless steel. Heater provides a 49 degree temperature rise at 0.5 GPM flow. Electrical characteristics are 120 Volts AC, 30 Amps, 60 Hz. See models below if a 49 degree temperature rise could produce hot water over 120 degrees.

1191 Instant-Flow Micro® tankless heater is similar to model 1190 and will provide up to a 49 degree temperature rise at 0.5 GPM flow. A factory preset microprocessor limits output temperature to 120 degrees for use with hot and cold faucets. Electrical characteristics are 120 Volts AC, 30 Amps, 60 Hz.

1192 Instant-Flow Micro® tankless heater is similar to model 1191. A factory preset microprocessor limits output temperature to 104 degrees for use with sensor or single temperature faucets. Electrical characteristics are 120 Volts AC, 30 Amps, 60 Hz.

Heaters are listed by Underwriters Laboratories, Inc. A 0.5 GPM inline flow control is provided for use with faucets without a flow control.

MODEL NUMBER:

- ☐ 1190 Instant Electric Water Heater
- ☐ 1191 Instant Electric Water Heater
- ☐ 1192 Instant Electric Water Heater

SELECTION SUMMARY & APPROVAL FOR MANUFACTURING

All dimensions are nominal and subject to manufacturer's change without notice. Murdock-Super Secur assumes no responsibility for use of void or suspended data. © Copyright 2006, Murdock-Super Secur, a division of Acorn Engineering Company. Please visit www.murdock-supersecur.com for most current specifications.

Model Numbers & Options _____ Quantity _____
 Company _____ Date _____
 Contact _____ Title _____
 Approval for Manufacturing/Signature _____