



P.O. Box 22326
Lincoln, NE 68542

PF: 402/421-9464 | WEBSITE: www.sitescapesonline.com
FX: 402/421-9479 | E-MAIL: info@sitescapesonline.com

TITLE *JORDAN CREEK
PLANTER*

PRODUCT NO.
JC4-1000

INCH TOLERANCES U.O.S.

FRACTION-- $\pm 1/16"$
ANG----- $\pm 1^\circ$

THE INFORMATION CONTAINED IN THIS DRAWING IS
THE SOLE PROPERTY OF SITESCAPES, INC. ANY
REPRODUCTION IN PART OR AS A WHOLE WITHOUT
THE WRITTEN PERMISSION OF SITESCAPES, INC.
IS PROHIBITED.

*Available in powder coat and DuraCoat finishes

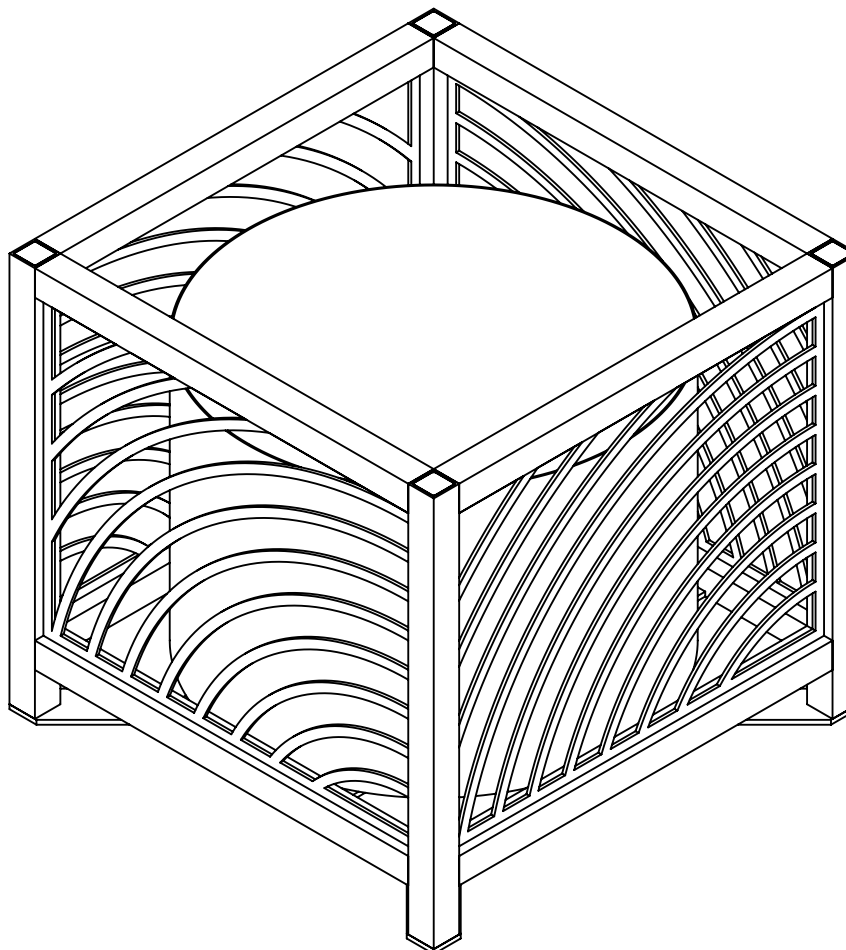



P.O. Box 22326
Lincoln, NE 68542

PF: 402/421-9464 | WEBSITE: www.sitescapesonline.com
FX: 402/421-9479 | E-MAIL: info@sitescapesonline.com

TITLE *JORDAN CREEK
PLANTER*

PRODUCT NO.
JC4-1000

INCH TOLERANCES U.O.S.

FRACTION-- $\pm 1/16"$
ANG----- $\pm 1^\circ$

THE INFORMATION CONTAINED IN THIS DRAWING IS
THE SOLE PROPERTY OF SITESCAPES, INC. ANY
REPRODUCTION IN PART OR AS A WHOLE WITHOUT
THE WRITTEN PERMISSION OF SITESCAPES, INC.
IS PROHIBITED.

*Available in powder coat and DuraCoat finishes

MATERIALS LIST

- (1) 1 1/2" SQ. Steel Tubing 11 GA. Wall
- (2) 1 1/2" SQ. Steel Tubing 11 GA. Wall
- (3) Foot Plates - 1/4" X 2 1/4" Stainless Steel
Flat Bar With $\phi 9/16"$ Mounting Holes
- (4) 11 GA. X 1 1/4" SQ. Mild Steel
- (5) 7 GA. Mild Steel Plate
- (6) 1/4" X 1" Steel Flat Bar
- (7) 1/4" X 1" Steel Flat Bar
- (8) 20 Gallon Plastics Liner With Handle Included

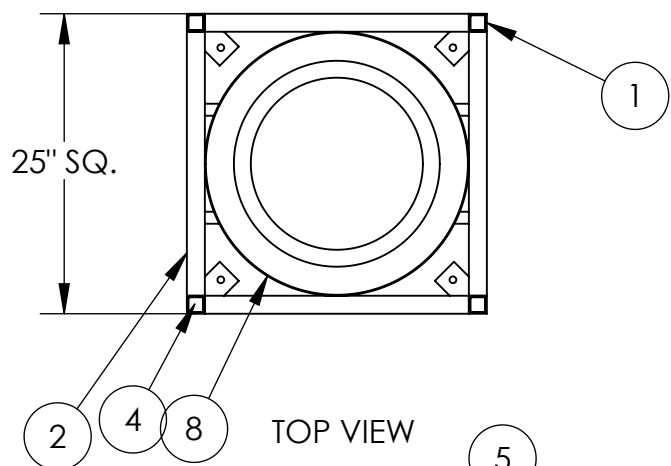

TOP VIEW

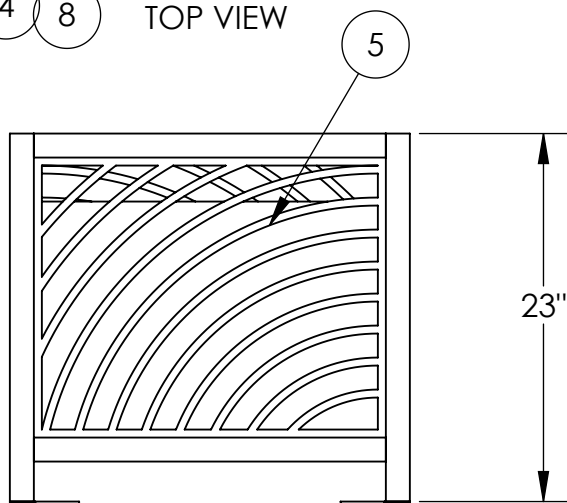

FRONT VIEW

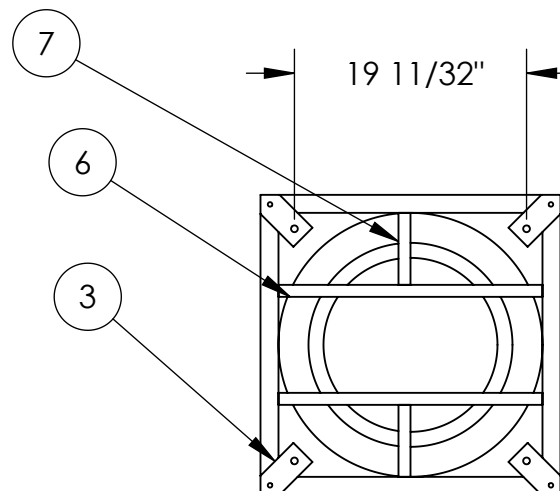

BOTTOM VIEW